

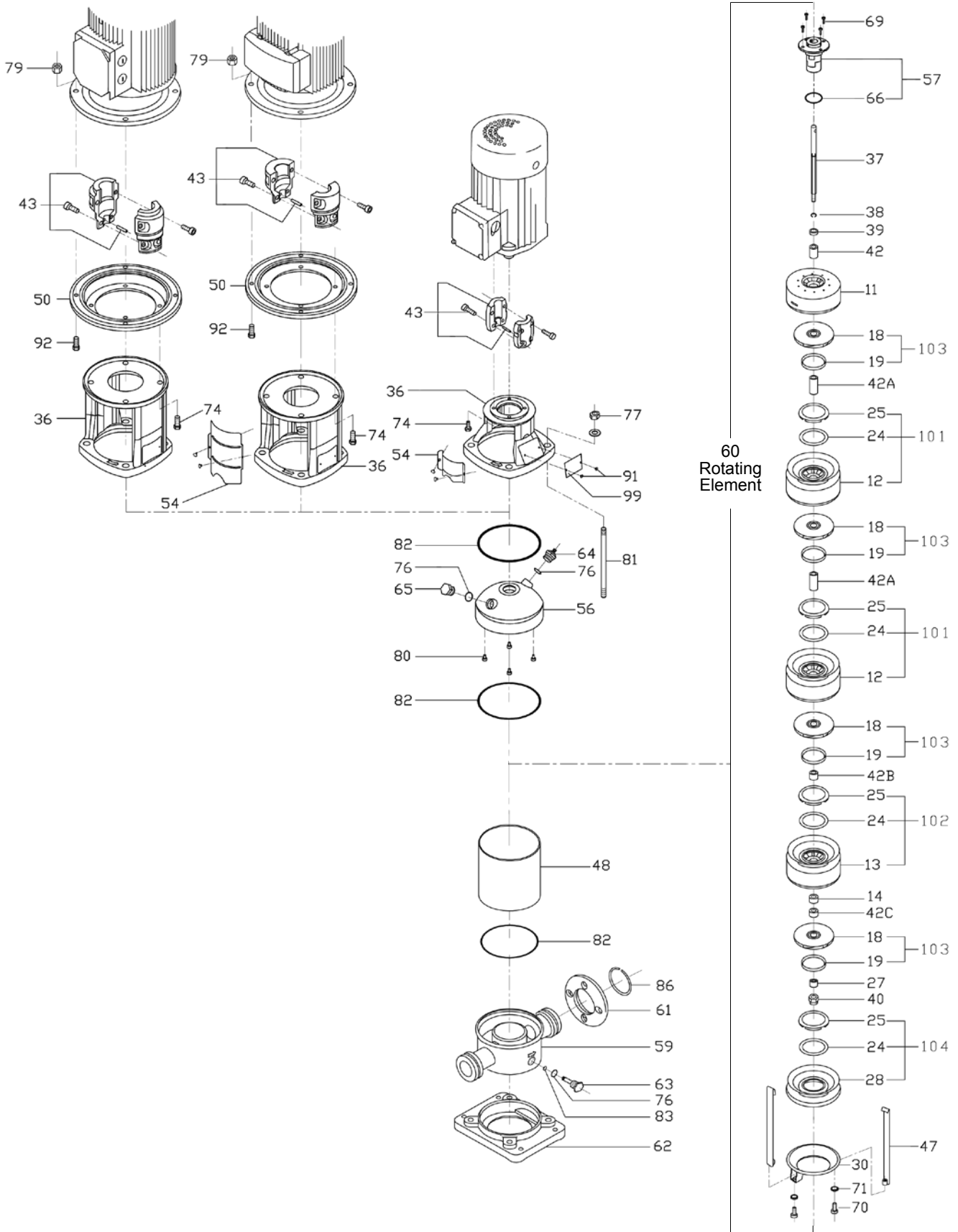

CENTRIFUGAL PUMPS

SBI(N)-20





CENTRIFUGAL PUMPS

SBI(N)-20

ILLUS. NO.	NO. PER UNIT	SBI PART NO.	SBN PART NO.	DESCRIPTION
11	1	SBI1541100	SBN1561100	Outlet Diffuser
12	as reqd.	SBI1541200	SBN1561200	Diffuser
13	as reqd.	SBI1541300	SBN1561300	Diffuser with Bearing
14	as reqd.	SBI1091400		Middle Bearing
18	as reqd.	SBI2041800	SBN2061800	Impeller
19	as reqd.	SBI1541900	SBN1561900	Bush
24	as reqd.	SBI1592400		Neck Ring
25	as reqd.	SBI1542500	SBN1562500	Neck Ring Retainer
27	1	SBI1092700	SBN1062700	Clamp Bush
28	1	SBI1542800	SBN1562800	Inlet Casing
30	1	SBI1093000	SBN1063000	Strap Retainer
36	1	SBI1063600A0 SBI1063600B0 SBI1063600C0 SBI1063600D0 SBI1063600E0 SBI1063600F0		Motor Stool
37	1	SEE PUMP SHAFT SELECTION CHART		Pump Shaft
38	1	SBI1063800		Spring Washer
39	1	SBI1093900(304)	SBN1063900(316)	Clamp Washer
40	1	(304SS)	(316SS)	Lock Nut (M8)
42	1	SBI1594200	SBN1564200	Spacing Bush
42A	1	SBI1594200A0	SBN1564200A0	Spacing Bush
42B	as reqd.	SBI1594200B0	SBN1564200B0	Spacing Bush
42C	1	SBI1594200C0	SBN1564200C0	Spacing Bush
43	1	SBI1094300A0 SBI1094300B0 SBI1094300C0 SBI1094300D0 SBI1094300E0 SBI1094300F0		Coupling Assembly (Ψ14) 0.37-0.55kW Coupling Assembly (Ψ19) 0.75-1.1kW Coupling Assembly (Ψ24) 1.5-2.2kW Coupling Assembly (Ψ28) 3-4kW Coupling Assembly (Ψ38) 5.5-7.5kW Coupling Assembly (Ψ42) 11-15kW
47	2	SEE STRAP SELECTION CHART		Strap
48	1	SEE PUMP CASING SELECTION CHART		Pump Casing
50	1	SBI1095000A0 SBI1095000B0		Adaptor Flange (5.5-7.5kW) Adaptor Flange (11-15kW)
54	2	SBI1045400A0 SBI1045400B0 SBI1045400C0 SBI1045400D0		Coupling Guard (0.37-1.1kW) Coupling Guard (1.5-4kW) Coupling Guard (5.5-7.5kW) Coupling Guard (11-18.5kW)
56	1	SBI1045600	SBN1065600	Pump Top Cap
57	1	SBI1095700	SBN1065700	Mechanical Shaft Seal
59	1	SBI1545900A0	SBN1565900A0	Pump Base
60	1	SEE ROTATING ELEMENT SELECTION CHART		Rotating Element
61	2	SBI1566100		Suction/Discharge Flange
62	1	SBI1566200		Base Plate
63	1	SBI1046300(304)	SBN1066300(316)	Drain Plug
64	1	SBI0196400	SBN0166400	Air Vent Screw
65	1	SBI0196500	SBN0166500	Plug



**CENTRIFUGAL PUMPS**

**SBI(N)-20**

ILLUS. NO.	NO. PER UNIT	SBI PART NO.	SBN PART NO.	DESCRIPTION
66	1	SBI15066E		O-ring (EPDM) A-123
		SBI15066V		O-ring (Viton)
69	4			Hexagon Socket Head Screw (M6)
70	2			Hexagon Socket Head Screw (M8)
71	2			Washer
74	4			Screw (M6x20) 0.37-0.5kW
				Screw (M6x25) 0.75-1.1kW
				Screw (M8x20) 1.5-2.2kW
				Screw (M8x25) 3-4kW
				Screw (M12x25) 5.5-7.5kW
				Screw (M16x45) 11-15kW
76	3	SBI15066E		O-ring (EPDM)
		SBI15066V		O-ring (Viton)
77	4			Nut and Washer (M16)
79	4			Nut (M12x35) 5.5-7.5kW
				Nut (M16x55) 11-15kW
80	4	SBI1098000E	SBN1098000E	Locating Buffer(EPDM)
		SBI1068000V	SBN1068000V	Locating Buffer (Viton)
81	4	SEE STAYBOLT SELECTION CHART		Staybolt
82	3	SBI1098200E	SBN1098200E	O-ring (EPDM)
		SBI1068200V	SBN1068200V	O-ring (Viton)
83	1	SBI15083E		O-ring (EPDM)
		SBI15083V		O-ring (Viton)
86	2	SBI1548600		Retaining ring (304SS)
92	4			Screw (M12x35) 5.5-7.5kW
				Screw (M16x55) 11-15kW
101	as reqd.	SBI15-K1	SBN15-K1	Diffuser Kit
102	as reqd.	SBI15-K2	SBN15-K2	Diffuser with Bearing Kit
103	as reqd.	SBI15-K3	SBN15-K3	Impeller Kit
104	1	SBI15-K4	SBN15-K4	Inlet Casing Kit

**SHAFT SELECTION CHART**

MODEL	SBI PART NO.	SBN PART NO.
SBI20-01	SBI159370001	SBN156370001
SBI20-02	SBI159370002	SBN156370002
SBI20-03	SBI159370003	SBN156370003
SBI20-04	SBI159370004	SBN156370004
SBI20-05	SBI159370005	SBN156370005
SBI20-06	SBI159370006	SBN156370006
SBI20-07	SBI159370007	SBN156370007
SBI20-08	SBI159370008	SBN156370008
SBI20-09	SBI159370009	SBN156370009
SBI20-10	SBI159370010	SBN156370010
SBI20-12	SBI159370012	SBN156370012
SBI20-14	SBI159370014	SBN156370014
SBI20-17	SBI159370017	SBN156370017

**STRAP SELECTION CHART**

MODEL	SBI PART NO.	SBN PART NO.
SBI20-01	SBI154470101	SBN156470001
SBI20-02	SBI154470102	SBN156470002
SBI20-03	SBI154470103	SBN156470003
SBI20-04	SBI154470104	SBN156470004
SBI20-05	SBI154470105	SBN156470005
SBI20-06	SBI154470106	SBN156470006
SBI20-07	SBI154470107	SBN156470007
SBI20-08	SBI154470108	SBN156470008
SBI20-09	SBI154470109	SBN156470009
SBI20-10	SBI154470110	SBN156470010
SBI20-12	SBI154470112	SBN156470012
SBI20-14	SBI154470114	SBN156470014
SBI20-17	SBI154470117	SBN156470017





**CENTRIFUGAL PUMPS**

**SBI(N)-20**

**PUMP CASING SELECTION CHART**

MODEL	SBI PART NO.	SBN PART NO.
SBI20-01	SBI154480001	SBN156480001
SBI20-02	SBI154480002	SBN156480002
SBI20-03	SBI154480003	SBN156480003
SBI20-04	SBI154480004	SBN156480004
SBI20-05	SBI154480005	SBN156480005
SBI20-06	SBI154480006	SBN156480006
SBI20-07	SBI154480007	SBN156480007
SBI20-08	SBI154480008	SBN156480008
SBI20-09	SBI154480009	SBN156480009
SBI20-10	SBI154480010	SBN156480010
SBI20-12	SBI154480012	SBN156480012
SBI20-14	SBI154480014	SBN156480014
SBI20-17	SBI154480017	SBN156480017

**ROTATING ELEMENT SELECTION CHART**

MODEL	SBI PART NO.	SBN PART NO.
SBI20-01	SBI20-01R	SBN20-01R
SBI20-02	SBI20-02R	SBN20-02R
SBI20-03	SBI20-03R	SBN20-03R
SBI20-04	SBI20-04R	SBN20-04R
SBI20-05	SBI20-05R	SBN20-05R
SBI20-06	SBI20-06R	SBN20-06R
SBI20-07	SBI20-07R	SBN20-07R
SBI20-08	SBI20-08R	SBN20-08R
SBI20-09	SBI20-09R	SBN20-09R
SBI20-10	SBI20-10R	SBN20-10R
SBI20-12	SBI20-12R	SBN20-12R
SBI20-14	SBI20-14R	SBN20-14R
SBI20-17	SBI20-17R	SBN20-17R

**STAYBOLT SELECTION CHART**

MODEL	SBI PART NO.	SBN PART NO.
SBI20-01	SBI154810001	SBI154810001
SBI20-02	SBI154810002	SBI154810002
SBI20-03	SBI154810003	SBI154810003
SBI20-04	SBI154810004	SBI154810004
SBI20-05	SBI154810005	SBI154810005
SBI20-06	SBI154810006	SBI154810006
SBI20-07	SBI154810007	SBI154810007
SBI20-08	SBI154810008	SBI154810008
SBI20-09	SBI154810009	SBI154810009
SBI20-10	SBI154810010	SBI154810010
SBI20-12	SBI154810012	SBI154810012
SBI20-14	SBI154810014	SBI154810014
SBI20-17	SBI154810017	SBI154810017