

HEBEFIX 100/100H

LIFTING STATIONS

The HEBEFIX range of collection tanks are the ideal solution where there is no direct access to a wastewater pipe for the disposal of dirty water from bathrooms, laundries or kitchens. Combining one of the selected Jung Pumpen pumps with a HEBEFIX above-floor tank creates a pump station for the storage and disposal of greywater effectively and efficiently.



KEY FEATURES

- Storage volume of 75 litres
- Temperatures up to 80°C
- Easy access sealed lid without dismantling pipework
- Six pump options

Introducing



HEBEFIX 100 / 100H

LIFTING STATIONS

THE IDEAL SOLUTION FOR DISPOSING OF GREYWATER WHERE THERE IS NO DIRECT CONNECTION TO THE WASTEWATER PIPE

Installing a bathroom (excl. WC connection), kitchen, laundry or simply a wash bay in a location where there is no drainpipe is made possible thanks to the Jung Pumpen HEBEFIX. The HEBEFIX collection chamber captures the wastewater and is pumped out to the waste line. The HEBEFIX 100 / 100H (hot water) are perfectly suited to use in commercial kitchens, laundries and restaurants.



HEBEFIX 100
capable of handling
wastewater
temperatures to
40°C, and
HEBEFIX 100H
to 80°C.

The HEBEFIX 100 / 100H are 75 litre free-standing plastic tanks with four combination inlets for pipes with external diameters of 50 or 110 mm.

With several pump and accessory options available, a solution to your wastewater disposal need can be found with Pentair Jung Pumpen's HEBEFIX 100 / 100H.

FEATURES

- Discharge direction variable
- Storage volume of 75 litres
- Wastewater temperatures to 80°C
- Easy access sealed lid w/o dismantling pipework
- Alarm system (optional accessory)
- Includes connection kit
- Activated carbon filter (Hebefix 100)
- 6 pump options to suit variety of applications

APPLICATIONS

Wastewater from domestic and commercial;

- Kitchens
- Dishwashers
- Bathrooms (excl. faeces)
- Laundries

100H



SCOPE OF SUPPLY

Plastic tank to house a pump, with mounted cover and seal, containing four combination inlets, connection sleeve DN 100 with clamps, plug-in seals and elastic connection, tank ventilation, activated carbon filter (Hebefix 100), cable inlet, tank pressure pipe enclosed (made of stainless steel – Hebefix 100H) and 1½" swing-type check valve, without pump.



PUMP RECOMMENDATIONS

FREE PASSAGE	HEBEFIX 100 (to 40°C)	HEBEFIX 100H (to 80°C)
10 mm	US62ES (JP44234)	
30 mm	US73ES (JP47370)	US73HES (JP44086)
10 mm	US102ES (JP44176)	
30 mm	US103ES (JP44237)	US103HES (JP44326)

MECHANICAL DATA

	HEBEFIX 100	HEBEFIX 100H
Volume	75 litres	75 litres
Dimensions L x W x H	570 x 390 x 500 mm	570 x 390 x 500 mm
Temperature Range	1 - 40°C	1 - 80°C
Weight	8.6 KG	12.3 KG
Part no.	JP09319	JP09348

SWITCHING HEIGHTS

PUMP	STANDARD FLOAT		LOW-LEVEL FLOAT	
	ON	OFF	ON	OFF
US62ES	245 mm	130 mm	160 mm	110 mm
US73ES / HES	245 mm	130 mm	160 mm	110 mm
US102ES	275 mm	160 mm	190 mm	140 mm
US103ES / HES	275 mm	160 mm	190 mm	140 mm

PERFORMANCE

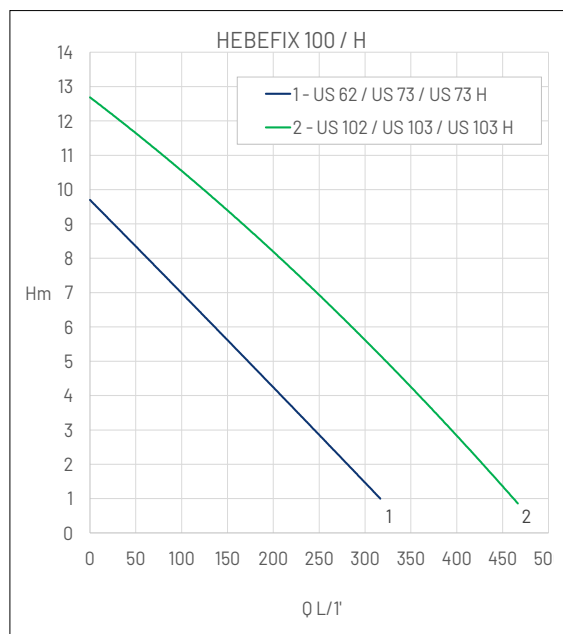

ACCESSORIES

ITEM	DESCRIPTION	PART NUMBER
Special Float (low level)	For lower switching points	JP447925
High Level Alarm	Audible & visual alarm at high level	PPC-12651-QP

DIMENSIONS

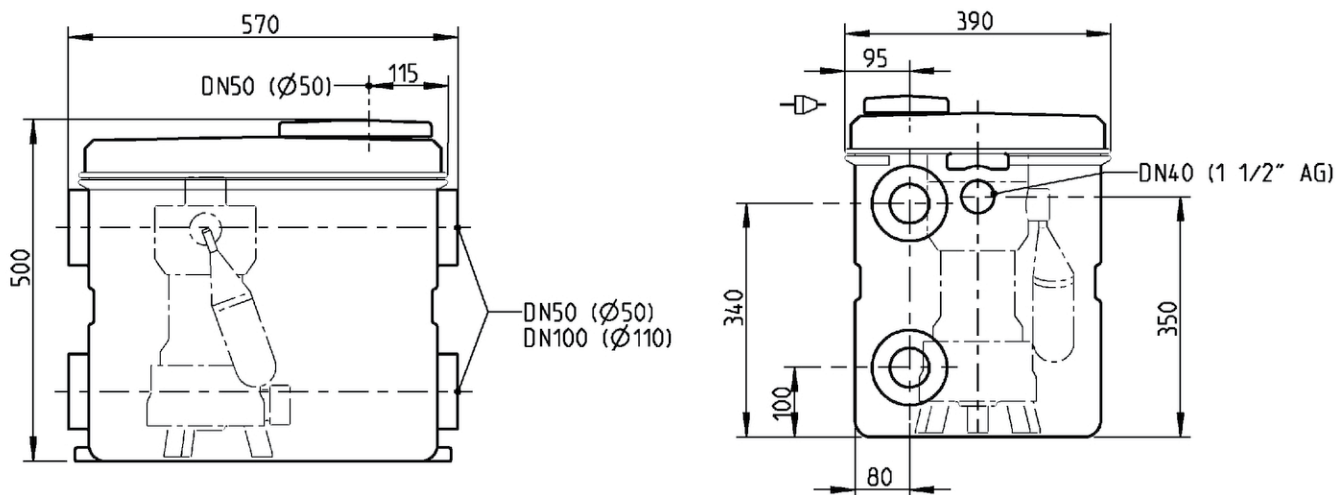

1-21 Monash Drive | Dandenong South, VIC 3175 | Australia | 1300 137 344 | pentair.com.au

Information contained here-in remains the property of Pentair under Australian copyright law. Content may not be reproduced or transmitted without our prior written permission.

© 2024 Pentair. All rights reserved. This document is subject to change without notice.